



This stylish, contemporary Litter Bin can cater for any application, from the toughest to the most prestigious of developments.



Town logos can be incorporated (if required).



Optional Levelling Plates instantly level the bin on different street gradients



Stubber Plate and Ash Hopper



Stainless Steel Rim with optional Restrictor Plate to restrict domestic waste from being deposited



HC2055 Litter Bin Product Specifications:

- Semi domed top cast ductile iron bin with half circle aperture 254 x 125mm.
- Elliptical in shape with 2 litter posting apertures.
- 100 litre capacity.
- Manufactured from 12mm cast ductile iron with 316 grade stainless steel.
- Extremely vandal and impact resistant.
- Dimensions 1080 x 430 x 390mm.
- Stainless steel aperture rim to protect paint work and prevent chipping.
- Fully galvanised with powder coat finish, as we manufacture all our products in house we can arrange any colour combination you require, see our colour palette section on page 109.
- Stainless steel stubber plate with key operated ash hopper. Common key for rubbish and ash bin access for easy emptying.
- Robust and anti-vandal hinging mechanism using 16mm stainless steel shaft on door.
- Heavy duty sealed plastic liner to prevent liquid leaking from bin.
- Supplied with detachable base plate both for ease of installation and removal without disturbing ground fixings.

Fitting: There are 4 fixing points on the base for fitting to the ground by means of anchoring bolts.

Concrete Foundations: Recommended concrete foundation 900 x 900 x 150mm.

Options Available:

- Galvanised steel liner is also available.
- A restrictor can be added to restrict access by birds and will also combat the problem of domestic waste dumping.
- Levelling plates to help cater for different street gradients.
- Town logos can be incorporated if required.

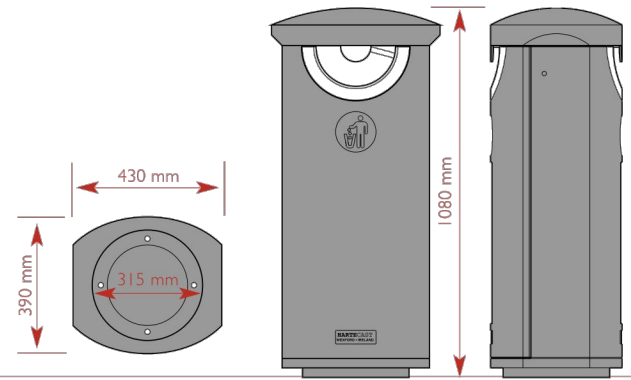

Detail 01
Covered bin: Hartecaste Bin HC2055

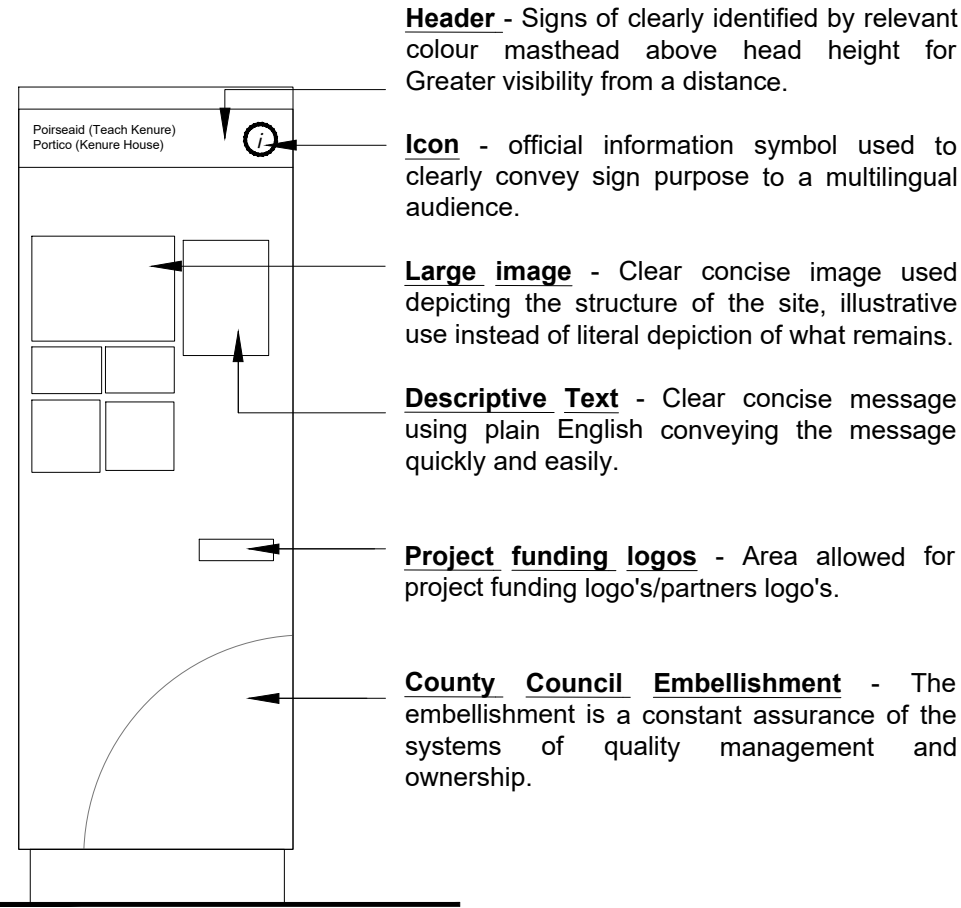
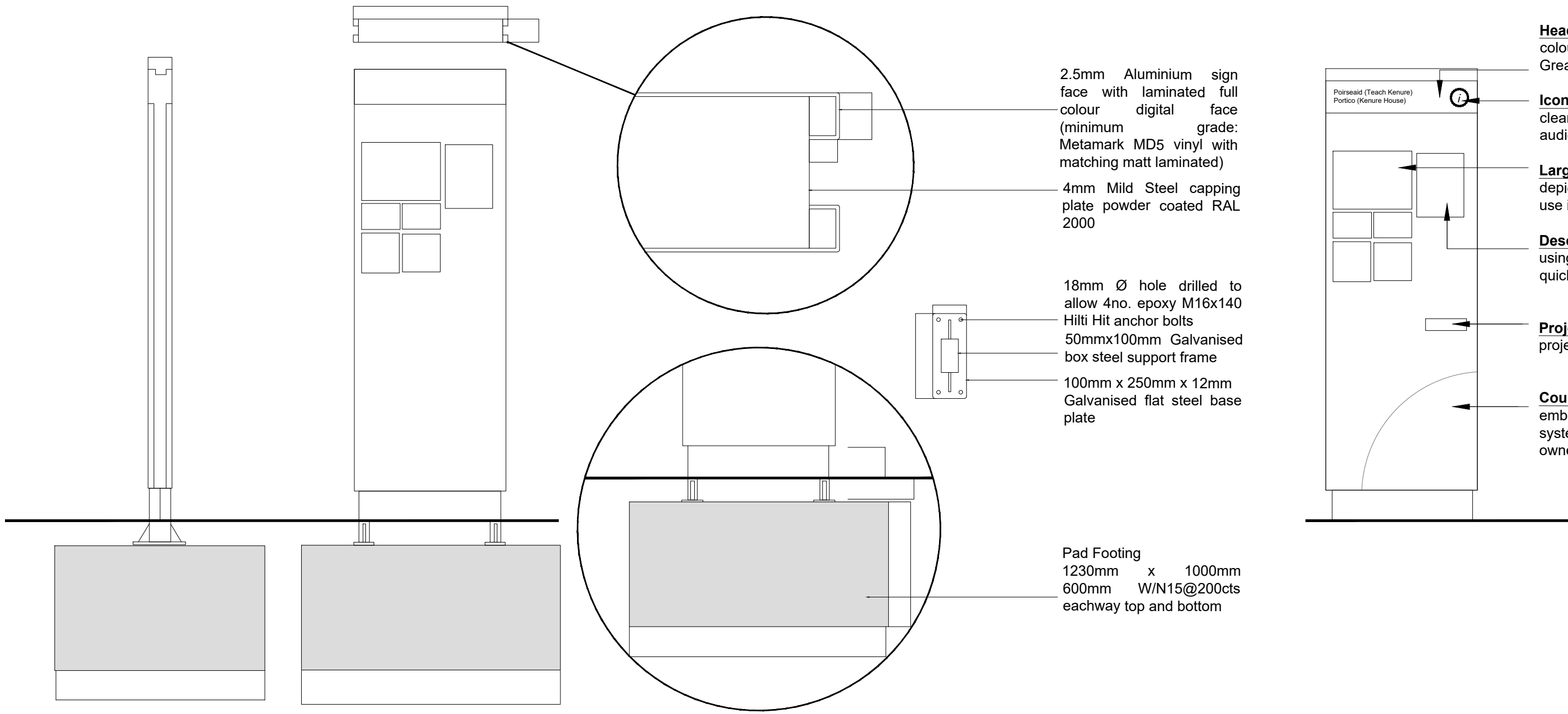

Detail 05
Freestanding Medilith Interpretive Display Signage
Scale 1:20



Detail 02
Bench: Supplied by Hartecaste - HC2026S Seat
Product Specifications

Standard length 1900mm. Supports are manufactured from 10mm cast ductile iron which is more durable than cast iron. The ductile iron components are fully galvanised and powder coated. Timber slats are 70 x 40mm composite timber. Fixtures and fittings are stainless steel. Arm rests to be added.

Fitting

Root Fixed – The root fixing is a base plate 130mm underground level with 4 fixing points on each support.

Concrete Foundations

Recommended concrete foundation 2000 x 800 x 150mm.

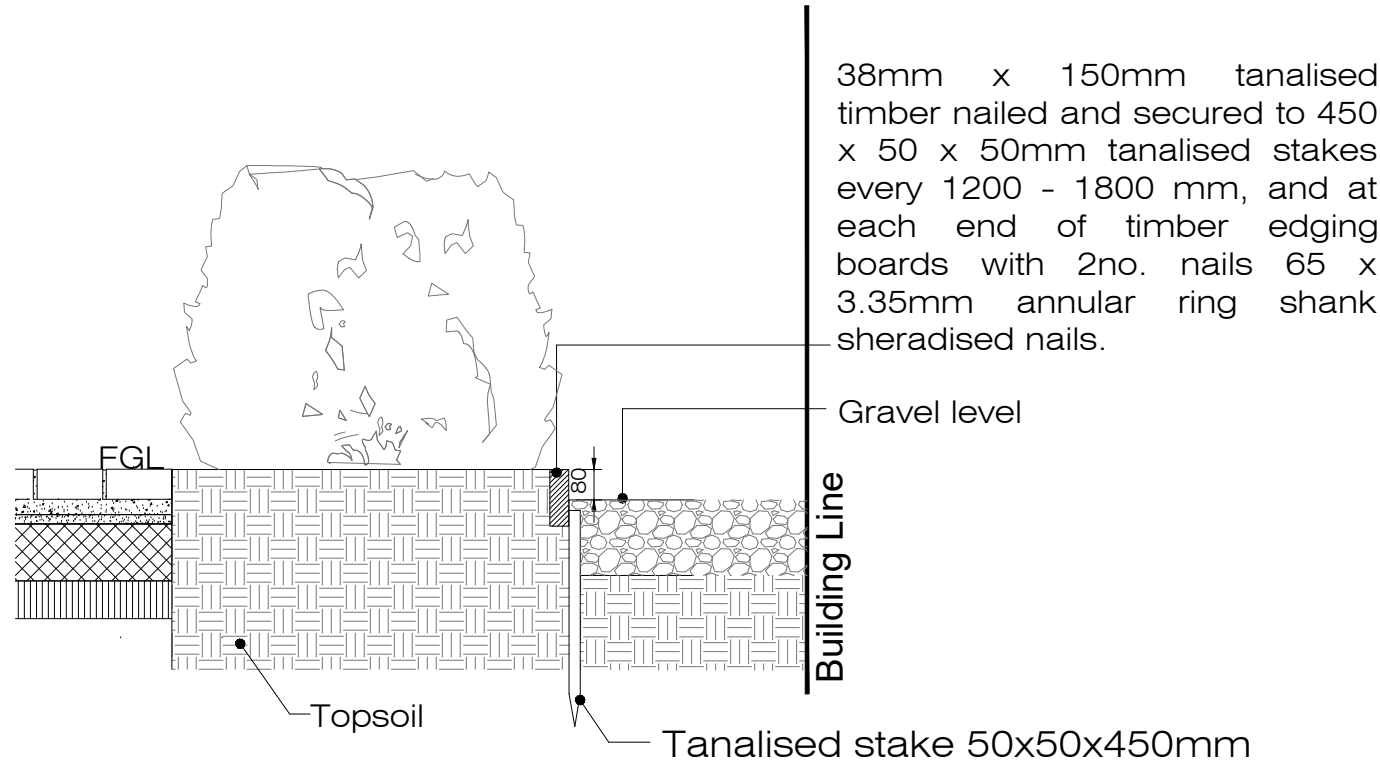

Detail 3: Timber Edge to Planting
Scale 1:20

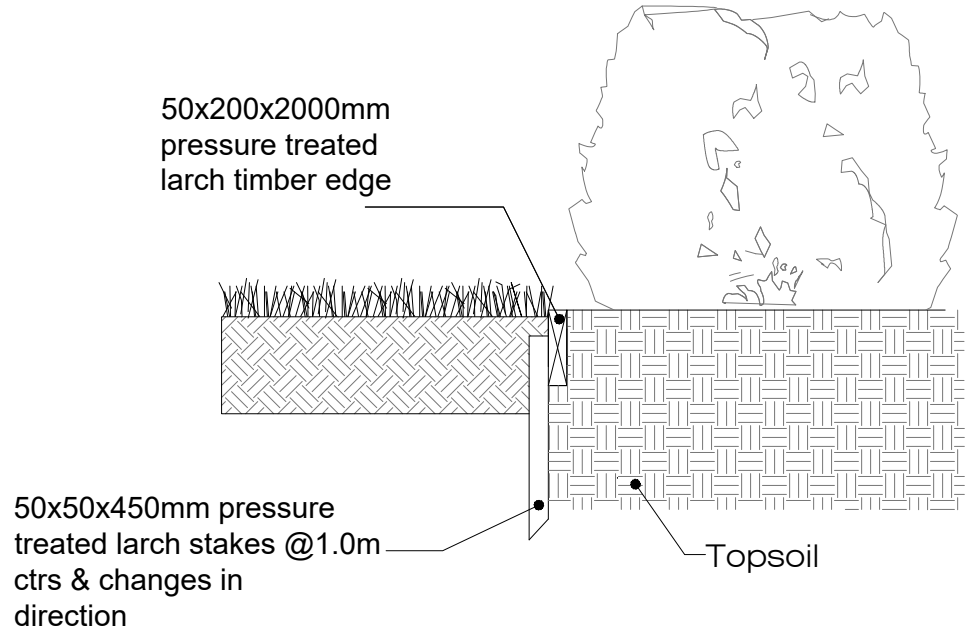

Detail 4: Timber Edge between grass and planted areas
Scale 1:20

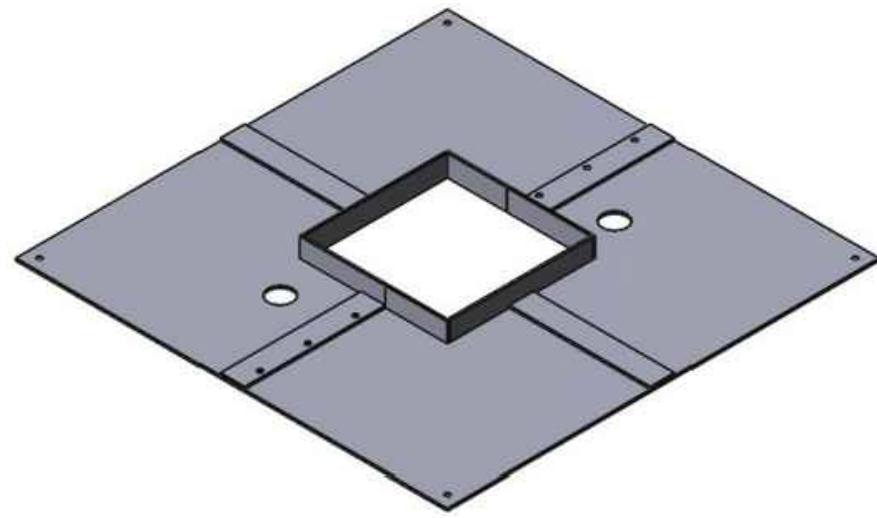

Detail 06 - The Castle Paving stone Tree Grate

Product Specifications

The Castle Pavingstone Tree Grate, allows for continued choice of paving over the tree pit area. Built-in irrigation/aeration inlets. The PavingStone Tree Grate is a square designed tree surround that provides a safe and load-bearing surface for pedestrian and vehicular traffic, while preventing compaction of the root ball zone. Supplied by Green Blue Urban or similar and approved.

Rev.	Date	Note
00	0000-00-00	00

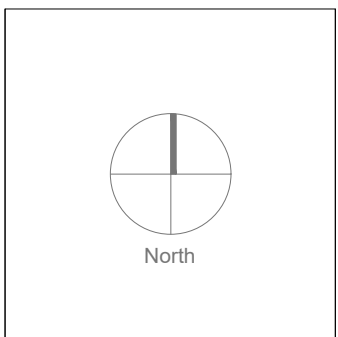

General Notes

Doyle &
O'Troithigh
Landscape
Architecture

Project Name Mooretown Phase 3 (SHD) Drawing Name Landscape Details 02

Status	Planning	Drawing No	LD-02-PP
Project No	21-003	Revision No	00
Scale	1:20	Drawn By	A.D.
Date	04/04/2022	Checked By	D'OT

Linda Doyle
Director
+353 (0)87 267 4196
linda@doyle-otroithigh.com

Daihi O'Troithigh
Director
+353 (0)86 300 3469
daihi@doyle-otroithigh.com

Office Address
Pembroke House
26-28 Upper Pembroke St
Dublin 2

Contact
mail@doyle-otroithigh.com
+353 (0)1 408 7762